



**Tobermore**

PAVING & WALLING

[www.tobermore.co.uk](http://www.tobermore.co.uk) |   

2018/19

paving & walling



4-5

#### **Landscape Design Services**

- 04 Landscape Design Services
- 05 Free Computer Visualisation

6-17

#### **Block Paving**

- 06 Tegula
- 08 Tegula Setts & Circles
- 10 Shannon
- 12 Hydropave Tegula Duo
- 13 Manhattan
- 14 Sienna
- 15 Sienna Setts & Circles
- 16 Pedesta
- 17 Retro

18-26

#### **Paving Flags**

- 18 Historic Flags & Circles
- 20 Mayfair Flags
- 21 Mayfair with EasyClean \*
- 22 Kensington Flags
- 23 Beaufort Flags
- 24 Textured Flags
- 25 Riven Flags
- 26 Standard Flags

27-30

#### **Walling**

- 27 Lansdowne & Kingston
- 28 Country Stone
- 29 Garden Stone
- 30 Secura Lite

31-38

#### **Kerbs, Edging, Steps & Accessories**

- 31 Kerbstone
- 32 Kerbsett
- 33 Kerb Small & Kerb Large
- 34 Tegula Kerb Large
- 35 Kerb Specials
- 36 Kerbs & Edging
- 37 Steps & Ramps
- 38 Accessories

39-40

#### **Important Information**

- 39 Reduced Efflorescence
- 39 Tobermore Approved
- 40 Instructions & Warnings

\* **NEW**

**25 year  
guarantee**

**25 year  
guarantee**

for domestic block paving products

Tobermore is proud of its quality assurance programme as well as its high standard of excellence. We guarantee the structural integrity of our paving blocks, when supplied for private use for a domestic project in a lightly trafficked area, for 25 years from the date of purchase. During this period, we will replace any paving blocks which fail to meet this guarantee, provided that they were suitable for use in relation to the relevant project and, if installed, were installed properly.

This guarantee is non-transferable, except upon any change of ownership of the premises, and does not cover installation defects or replacement works. It does not confer any rights other than those expressly stated and does not cover any claims for consequential loss or damage. This guarantee is offered as an extra benefit and does not affect your statutory rights as a consumer.









# landscape design services

## premier on-site

### hard landscape design service

Book an appointment with one of our qualified landscape designers and receive an on-site consultation on hard landscaping for an agreed fee. This service is suitable for large projects that require design on more than one area of the scheme.

When a designer is on site they will measure your area(s), discuss our product choices and draw out a concept sketch. The designer will then take the drawing away to make any amendments and to finalise the plan. Within two weeks of the site visit you will receive a CAD plan to scale and a priced quotation.

fees  
will be  
refunded  
on purchase  
of Tobermore  
products

terms & conditions apply

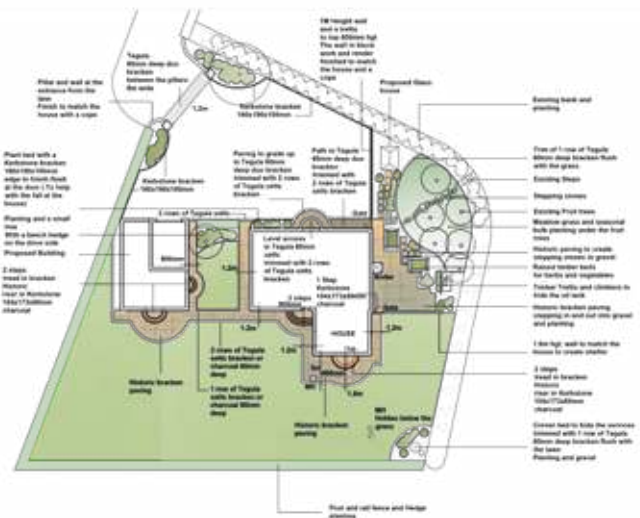

## 90min on-site

### hard landscape design service

Book an appointment with one of our qualified landscape designers and receive a 90 minute on-site consultation on hard landscaping for an agreed fee. This service is suitable for patios or driveways.

When a designer is on site they will measure your area(s), discuss your product choices and draw out a concept sketch. The designer will then take the drawing away to make any amendments and to finalise the plan. Within two weeks of the site visit you will receive a CAD plan to scale and a priced quotation.

fees  
will be  
refunded  
on purchase  
of Tobermore  
products

terms & conditions apply

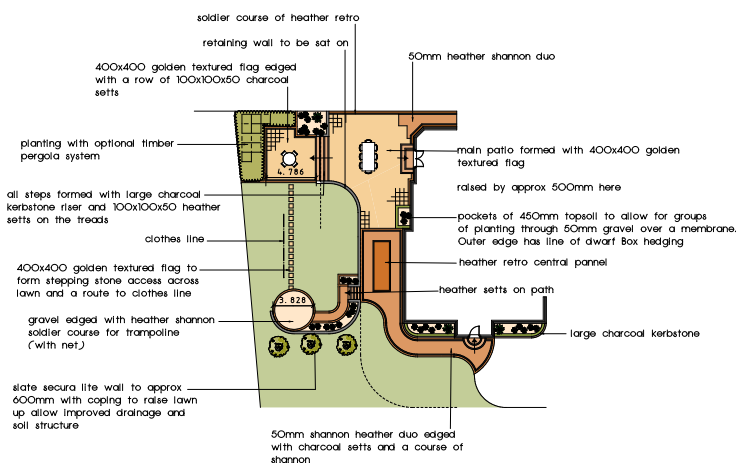

NOTE: charcoal setts could be replaced by golden setts

For further information on any of our services or to book an appointment with a landscape designer, contact your nearest Paving & Walling Centre.

**30min free**

hard landscape  
design service

Book an appointment with one of our qualified landscape designers and receive one **free** 30 minute design consultation on hard landscaping at your nearest Paving & Walling Centre. This service is ideal for small areas such as patios.

When you meet with the designer he/she will assess your requirements and provide you with a hand drawn sketch. Our sales staff will be on hand to advise you on products and provide you with samples. Within one week of your appointment you will receive a priced quotation, based on the measurements provided, for the products listed in the design.

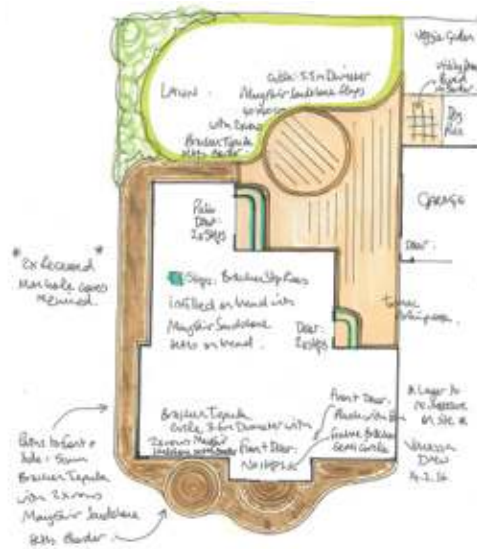

**computer  
visualisation free\***

bringing your ideas  
to life

\*One computer visualisation per customer.

Take a digital photo of the area you would like visualised and bring it along to your nearest Tobermore paving & walling centre where trained staff will be on hand to advise you on the best products to suit your style and budget.

Alternatively, email the photo to [images@tobermore.co.uk](mailto:images@tobermore.co.uk) with a brief description of your preferred style, products and what the area will be used for e.g. patio or driveway etc. Within a few days Tobermore will email you a visualisation of your project - you will be amazed at the transformation of your home!





Tegula is manufactured with an aged antique appearance, similar to weathered stone. It is the perfect choice for a modern residence or for adding a touch of character to a period residence.

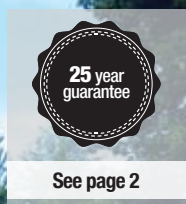

product	size (mm)	colours available	in stock	m <sup>2</sup> per pack	m <sup>2</sup> per slice	no. per m <sup>2</sup>	no. per pack	weight (kg) per pack
TEGULA 50mm	175 x 140 x 50	Bracken, Cedar, Charcoal, Heather, Slate	YES	15.43	2.2	40.82	630	1714
	140 x 140 x 50	Bracken, Cedar, Charcoal, Heather, Slate	YES	15.87	1.76	51	810	1765
TEGULA TRIO 50mm (all three sizes in one pack) [VOID PACK]	197 x 173 x 50	Bracken, Brindle, Cedar, Charcoal, Golden, Heather, Slate	YES	13.05	1.05	33.3	174	1453
	173 x 173 x 50						174	
	130 x 173 x 50						87	
TEGULA 60mm	208 x 173 x 60	Bracken, Cedar, Charcoal, Heather, Natural, Slate	YES	12.95	2.16	27.79	360	1800
	173 x 173 x 60	Bracken, Cedar, Charcoal, Heather, Natural, Slate	YES	12.56	1.79	33.41	420	1733
TEGULA TRIO 60mm (all three sizes in one pack)	208 x 173 x 60	Bracken, Cedar, Charcoal, Heather, Slate	YES	10.5	1.05	33.3	120	1465
	173 x 173 x 60						110	
	138 x 173 x 60						120	

**SIZES:** OTHER SIZES AVAILABLE ON REQUEST **INSTRUCTIONS & WARNINGS:** See page 40





Tegula Bracken with Tegula Setts Bracken



# tegula setts & circles

Tegula Setts are the ideal product for bordering any of the Tobermore paving products. They blend perfectly with products such as Tegula and Retro but also provide the essential contrast to the modern finishes of Sienna or Shannon. Tegula Setts can also be used independently and can recreate the old cobbled effect of yesteryear.

25 year  
guarantee

See page 2

## SETT SIZES

90mm x VARIOUS



100mm x 100mm



SETTS



CIRCLE

HEATHER

Tegula Heather with Tegula Setts & Circles Heather and Step Risers Heather



SETTS



SETTS



SETTS



SETTS



CIRCLE



CIRCLE



CIRCLE



CIRCLE

product	size (mm)	colours available	in stock	m <sup>2</sup> per pack	m <sup>2</sup> per slice	no. per m <sup>2</sup>	no. per pack	weight (kg) per pack
TEGULA SETTS 50mm	various x 50	Bracken, Charcoal, Golden, Heather, Natural	YES	8.5	0.85	117	995	920
	100 x 100 x 50	Bracken, Charcoal, Golden, Heather	YES	11.52	0.96	100	1152	1205
TEGULA SETTS 60mm	various x 60	Bracken, Charcoal, Golden, Heather, Natural	YES	6.8	0.85	117	796	862
TEGULA CIRCLE (Sold as one unit)	50 x 1.5m diameter	Bracken, Charcoal, Golden, Heather, Natural	YES	-	1.76 per circle	-	-	200
	60 x 1.5m diameter	Bracken, Charcoal, Golden, Heather	YES	-	1.76 per circle	-	-	239

SIZES: OTHER SIZES AVAILABLE ON REQUEST INSTRUCTIONS & WARNINGS: See page 40





Tegula Setts Charcoal with Tegula Bracken and Charcoal



# shannon

## beautiful, vibrant colours

Shannon's smooth surface makes it ideal for children's activities such as skateboards, scooters, rollerblades and push toys. It's close fitting joints and small bevelled edges help minimise maintenance and creates a neat and spacious appearance.

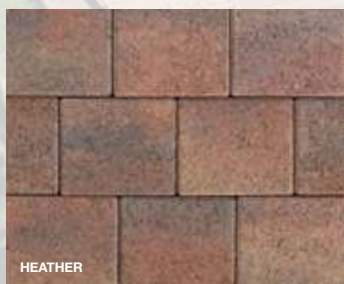
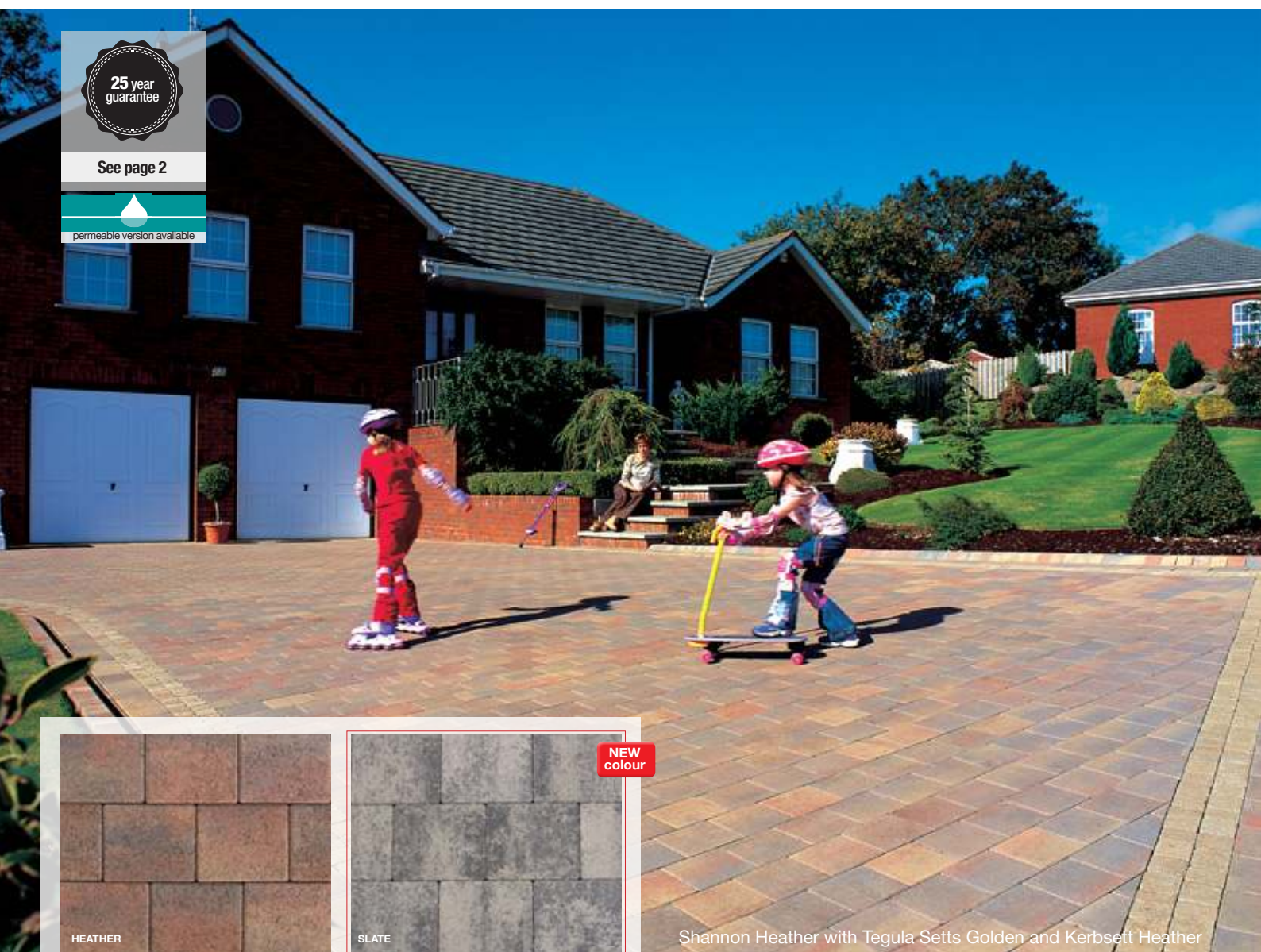

HEATHER

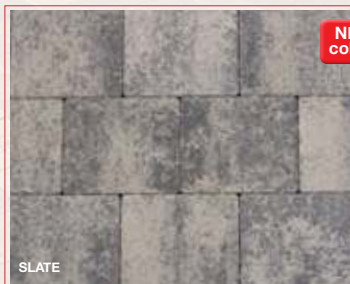

SLATE

NEW  
colour



BRACKEN



BRINDLE



NATURAL



CHARCOAL

Shannon Heather with Tegula Setts Golden and Kerbsett Heather

product	size (mm)	colours available	in stock	m <sup>2</sup> per pack	m <sup>2</sup> per slice	no. per m <sup>2</sup>	no. per pack	weight (kg) per pack
SHANNON 50mm	208 x 173 x 50	Bracken, Charcoal, Heather	YES	14.04	2.34	27.79	390	1628
SHANNON 50mm [VOID PACK]	208 x 173 x 50	Brindle, Natural, Slate	YES	13.32	1.08	27.79	370	1545
SHANNON DUO 50mm (both sizes in one pack)	208 x 173 x 50 173 x 173 x 50	Bracken, Charcoal, Heather, Slate	YES	13.86	0.99	30.3	210 210	1607
SHANNON 60mm	208 x 173 x 60	Bracken, Charcoal, Heather, Natural	YES	12.96	2.16	27.79	360	1782
SHANNON DUO 60mm (both sizes in one pack)	208 x 173 x 60 173 x 173 x 60	Bracken, Charcoal, Heather	YES	12.87	0.99	30.3	195 195	1805

OTHER HYDROPAVE PRODUCTS ARE AVAILABLE ON REQUEST **INSTRUCTIONS & WARNINGS:** See page 40





Shannon Bracken with Tegula Setts Bracken



# hydropave tegula duo

## permeable elegance

Hydropave Tegula Duo permeable paving combines the aesthetics of Tegula and the environmental benefits of a permeable paving system that reduces the risk of flooding and pollution.

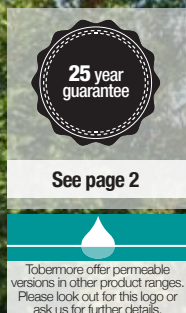

Tegula Slate (for colour reference only)



The swatches below are for colour reference only. The actual block profile will be as per swatches above.



product	size (mm)	colours available	in stock	m <sup>2</sup> per pack	m <sup>2</sup> per slice	no. per m <sup>2</sup>	no. per pack	weight (kg) per pack
HYDROPAVE TEGULA DUO (both sizes in one pack)	208 x 173 x 60 173 x 173 x 60	Bracken, Cedar, Charcoal, Heather, Slate	YES	12.87	0.99	30	195 195	1711

**SIZES:** OTHER SIZES AVAILABLE ON REQUEST **INSTRUCTIONS & WARNINGS:** See page 40



# contemporary linear paving

manhattan

Manhattan is produced in mixed length units with a beautiful granite aggregate finish that produces a look similar to natural granite. Manhattan provides stunning design possibilities for your home and is the perfect choice for creating a stylish outdoor space.



Manhattan Silver with Kerbstone Charcoal



GRAPHITE



SANDSTONE



SILVER

### IMPORTANT INFORMATION

Manhattan 80mm product is specifically designed for pedestrian use only. It should not be trafficked by vehicles.

product	size (mm)	colours available	in stock	m <sup>2</sup> per pack	m <sup>2</sup> per slice	no. per m <sup>2</sup>	no. per pack	weight (kg) per pack
MANHATTAN	Mixed length x 80	Graphite, Sandstone, Silver	YES	9.6	0.96	20.7	200	1755

SIZES: OTHER SIZES AVAILABLE ON REQUEST INSTRUCTIONS & WARNINGS: See page 40



# sienna

## vibrant, granite appearance

Sienna's coarse textured surface exposes the sparkling granite aggregates to provide a distinctive appearance similar to natural granite. It provides the aesthetic qualities which can match the traditional splendour of period design or add character to modern buildings.



Sienna Silver



SANDSTONE



SILVER



GRAPHITE

### IMPORTANT INFORMATION

Light coloured blocks emphasise tyre marks and oil spills on the driveway. It must be accepted that these products will need more maintenance if the overall appearance is to be maintained.

product	size (mm)	colours available	in stock	m <sup>2</sup> per pack	m <sup>2</sup> per slice	no. per m <sup>2</sup>	no. per pack	weight (kg) per pack
SIENNA 50mm	208 x 173 x 50	Graphite, Sandstone, Silver	YES	14.04	2.34	27.79	390	1628
SIENNA DUO 50mm (both sizes in one pack)	208 x 173 x 50	Graphite, Sandstone, Silver	YES	13.86	0.99	30.3	210	1607
	173 x 173 x 50						210	
SIENNA 60mm	208 x 173 x 60	Graphite, Sandstone, Silver	YES	12.96	2.16	27.79	360	1822
SIENNA DUO 60mm (both sizes in one pack)	208 x 173 x 60	Graphite, Sandstone, Silver	YES	12.87	0.99	30.3	195	1808
	173 x 173 x 60						195	

**SIZES:** OTHER SIZES AVAILABLE ON REQUEST **INSTRUCTIONS & WARNINGS:** See page 40



vibrant, granite appearance

Sienna Setts & Circles can be used over large areas to create the effect of granite cobbles. They are also an ideal product for bordering products such as Tegula and Retro or for creating an essential contrast to the modern finishes of Sienna or Shannon.

sienna setts  
& circles

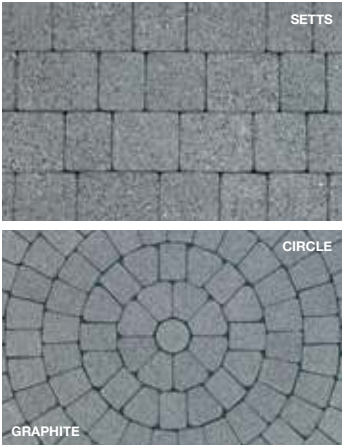
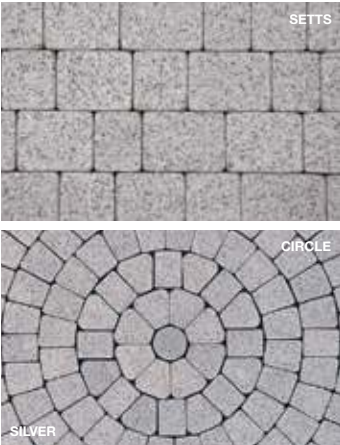

**IMPORTANT INFORMATION**

Light coloured blocks emphasise tyre marks and oil spills on the driveway. It must be accepted that these products will need more maintenance if the overall appearance is to be maintained.

product	size (mm)	colours available	in stock	m <sup>2</sup> per pack	m <sup>2</sup> per slice	no. per m <sup>2</sup>	no. per pack	weight (kg) per pack
SIENNA SETTS	100 x 100 x 50	Graphite, Sandstone, Silver	YES	11.52	0.96	100	1152	1335
	various x 60		YES	12.35	0.95	117	1445	1727
SIENNA CIRCLE (sold as one unit)	60 x 1.5m diameter	Graphite, Sandstone, Silver	YES	-	1.76 per circle	-	-	245

SIZES: OTHER SIZES AVAILABLE ON REQUEST INSTRUCTIONS & WARNINGS: See page 40



This is a popular choice if you want to create simple, yet distinctive patterns with paving on your driveway or in the garden. The rectangular shape of Pedesta makes it highly versatile. Design possibilities include herringbone, stretcher and double V.

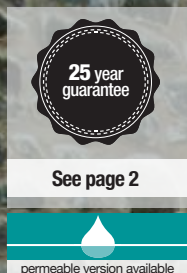

Pedesta Bracken

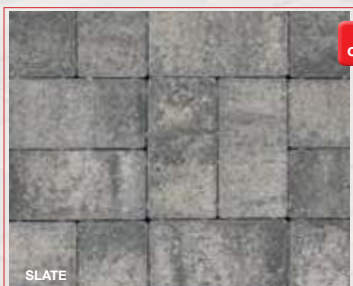

NEW  
colour



product	size (mm)	colours available	in stock	m <sup>2</sup> per pack	m <sup>2</sup> per slice	no. per m <sup>2</sup>	no. per pack	weight (kg) per pack
PEDESTA 50mm [VOID PACK]	200 x 100 x 50	Bracken, Brindle, Charcoal, Heather, Slate	YES	13.76	0.96	50	688	1545
PEDESTA 60mm	200 x 100 x 60	Bracken, Brindle, Charcoal, Heather	YES	13.44	2.24	50	672	1800

**SIZES:** OTHER SIZES AVAILABLE ON REQUEST **INSTRUCTIONS & WARNINGS:** See page 40



# unique, stunning appearance

Retro has a warm, aged appearance which recreates the cobbled look that was popular in many European towns and villages in years gone by. Retro can be combined with other Tobermore products such as Tegula Setts to create contrasting designs and textures. It can also be laid in the popular herringbone pattern.

retro



Retro Heather with Tegula Setts Golden



Retro Bracken



HEATHER



BRACKEN

### IMPORTANT INFORMATION

Retro is specifically designed for pedestrian use only. It should not be trafficked by vehicles.

product	size (mm)	colours available	in stock	m <sup>2</sup> per pack	m <sup>2</sup> per slice	no. per m <sup>2</sup>	no. per pack	weight (kg) per pack
RETRO	190 x 50 x 60	Bracken, Heather	YES	6.5	2 or 4	105.3	684	810

INSTRUCTIONS & WARNINGS: See page 40



# historic flags & circles

Historic Flags provide the look and feel of traditional natural stone with similar hard wearing characteristics. The fettled edges and riven face add to the warmth and charm of these flags and make them ideal for both old and new properties.

- HARD-WEARING SURFACE, FROST PROOF, 50MM DEPTH
- CAN BE LAID QUICKLY ON SAND BED - AVOIDING EXPENSIVE MORTAR BASE

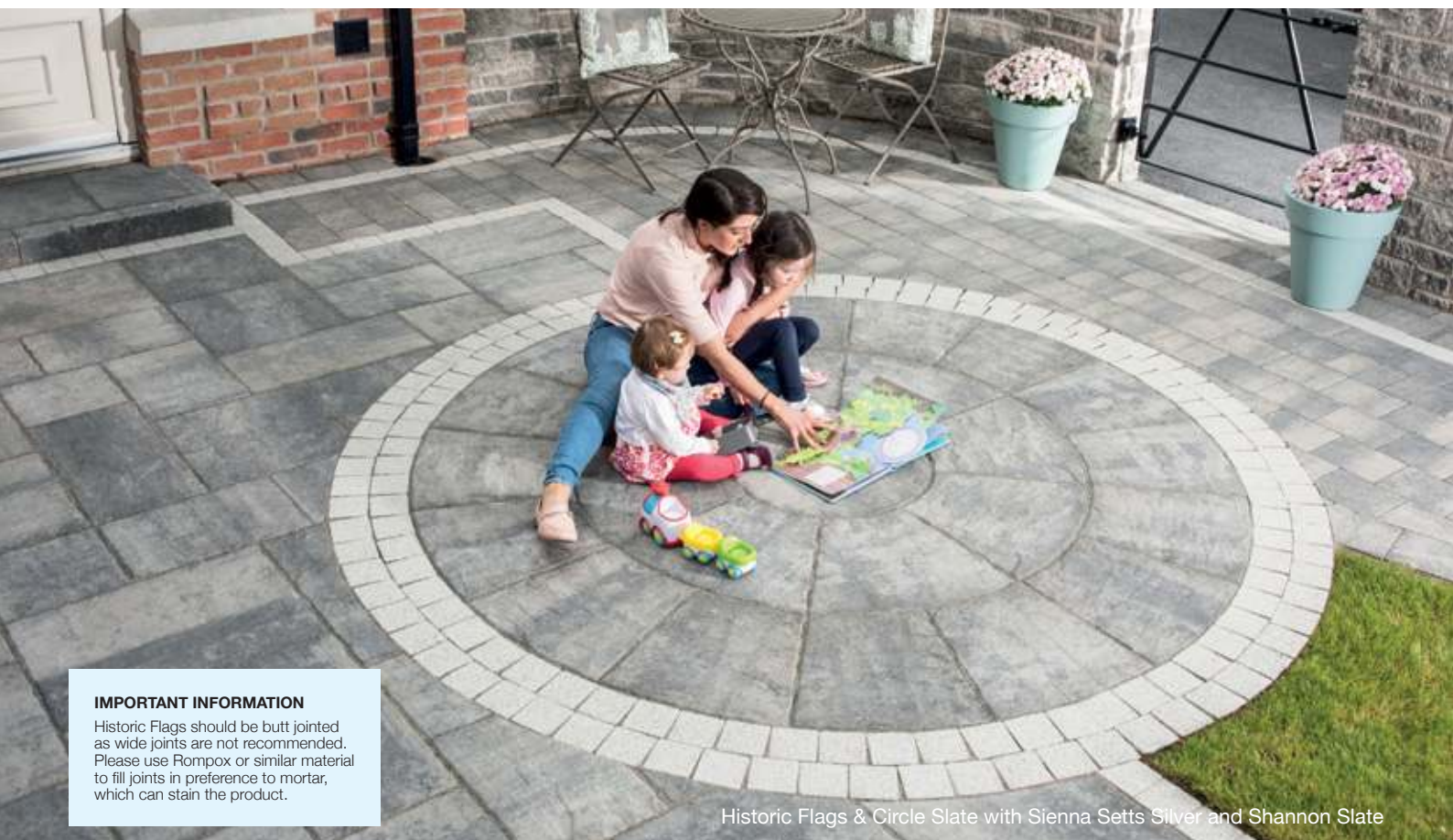

## IMPORTANT INFORMATION

Historic Flags should be butt jointed as wide joints are not recommended. Please use Rompox or similar material to fill joints in preference to mortar, which can stain the product.

Historic Flags & Circle Slate with Sienna Setts Silver and Shannon Slate



NEW  
colour



product	size (mm)	edge	colours available	in stock	no. per m <sup>2</sup>	no. per pack	weight (kg) per pack
HISTORIC FLAGS (all sizes in one pack)	600 x 450 x 50	FETTLED	Bracken, Harvest Gold, Heather, Slate	YES	10.8 m <sup>2</sup> per pack	10	1228
	600 x 300 x 50					10	
	450 x 450 x 50					20	
	450 x 300 x 50					10	
	300 x 300 x 50					10	
HISTORIC CIRCLE (sold as one unit)	50 x 2.24m diameter	FETTLED	Bracken, Harvest Gold, Heather, Slate	YES	3.94 m <sup>2</sup> per pack	-	455

INSTRUCTIONS & WARNINGS: See page 40





Historic Flags Bracken with Kerbstone Charcoal



# mayfair flags

vibrant, granite appearance

Mayfair Flags have a natural granite aggregate surface finish which make them ideal for both contemporary and conservation projects.



SANDSTONE

Mayfair Flags Sandstone with Tegula Setts Heather



SILVER

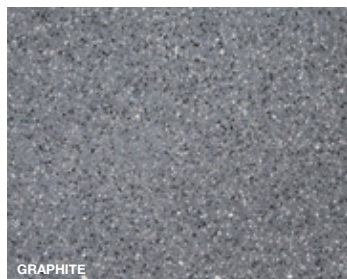

GRAPHITE

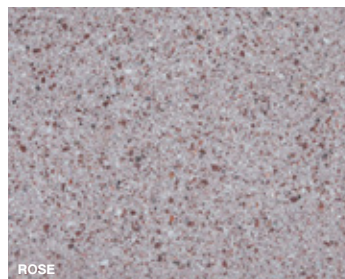

ROSE

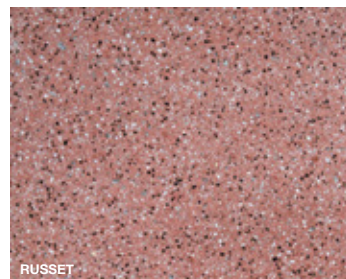

RUSSET

product	size (mm)	finish	edge	colours available	in stock	no. per m <sup>2</sup>	no. per pack	weight (kg) per pack
MAYFAIR FLAGS	400 x 400 x 40	GRANITE TEXTURED	CHAMFERED	Graphite, Rose, Russet, Sandstone, Silver	YES	6.25	25	382
	600 x 600 x 50	GRANITE TEXTURED	CHAMFERED	Graphite, Sandstone, Silver	YES	2.78	20	851
	600 x 400 x 50	GRANITE TEXTURED	CHAMFERED	Graphite, Sandstone, Silver	YES	4.16	20	584
Edge Step	400 x 400 x 40	GRANITE TEXTURED (top & 1 edge)	CHAMFERED	Graphite, Sandstone, Silver	YES	6.25	25	401
	600 x 400 x 50	GRANITE TEXTURED (top & 1 edge)	CHAMFERED	Graphite, Sandstone, Silver	YES	4.16	20	584
Corner Step	400 x 400 x 40	GRANITE TEXTURED (top & 2 edges)	CHAMFERED	Graphite, Sandstone, Silver	YES	6.25	25	401
	600 x 400 x 50	GRANITE TEXTURED (top & 2 edges)	CHAMFERED	Graphite, Sandstone, Silver	YES	4.16	20	584

The colour of Mayfair Step Flags may slightly vary to the normal Mayfair Flag.

**SIZES:** OTHER SIZES AVAILABLE ON REQUEST **INSTRUCTIONS & WARNINGS:** See page 40



The Mayfair paving range with natural granite aggregates is now available with EasyClean providing the smart choice for the modern home.

**new** mayfair with  
EasyClean



Mayfair with EasyClean Silver

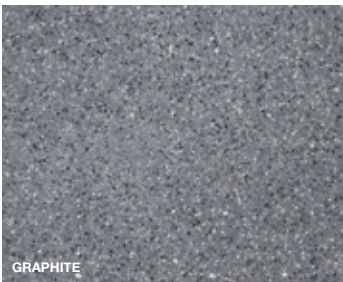

product	size (mm)	finish	colours available	in stock	no. per m <sup>2</sup>	no. per pack	weight (kg) per pack
MAYFAIR WITH EASYCLEAN	400 x 400 x 40	GRANITE TEXTURED/COATED	Graphite, Sandstone, Silver	YES	6.25	25	382
	450 x 450 x 35	GRANITE TEXTURED/COATED	Graphite, Sandstone, Silver	YES	4.94	30	851
	600 x 400 x 50	GRANITE TEXTURED/COATED	Silver	YES	4.16	20	584

INSTRUCTIONS & WARNINGS: See page 40



# kensington flags

Kensington Flags are one of Tobermore's premier products in the large element paving range. They are available in one striking colour blend which can be edged with contrasting paving products such as Tegula Setts, Sienna Setts or Retro. The unique colour blend produce a stunning marbling effect, making it the ideal product for both contemporary and traditional patios.



Kensington Flags White/Black



product	size (mm)	finish	edge	colours available	in stock	no. per m <sup>2</sup>	no. per pack	weight (kg) per pack
KENSINGTON FLAGS	400 x 400 x 40	TEXTURED	CHAMFERED	Black/White	YES	6.25	25	400

**INSTRUCTIONS & WARNINGS:** See page 40



Beaufort Flags are manufactured with a contoured surface that is lightly embossed and finished with a subtle sparkle. The product offers a contemporary look that bears a resemblance to natural stone. Beaufort Flags are available in three natural, muted colours, all of which are suitable for incorporation on patios and paths. The beauty of the product is that it is easily maintained and hugely versatile so it can be used to complement any home whether modern or traditional in style.

# beaufort flags



Beaufort Flags Natural and Charcoal with Kerbstone Cedar



BUFF

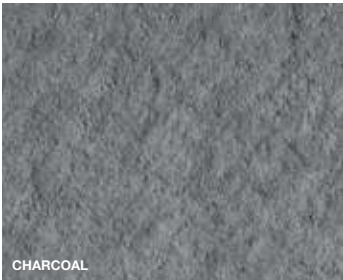

CHARCOAL



NATURAL

product	size (mm)	finish	edge	colours available	in stock	no. per m²	no. per pack	weight (kg) per pack
BEAUFORT FLAGS	400 x 400 x 40	CONTOURED	CHAMFERED	Buff, Charcoal, Natural	YES	6.25	25	400
	600 x 400 x 40	CONTOURED	CHAMFERED	Buff, Charcoal, Natural	YES	4.16	25	560

INSTRUCTIONS & WARNINGS: See page 40



# textured flags

Textured Flags are one of the premier products in this range. Their unique granular surface and mellow colours create a natural and timeworn appearance. Areas of Textured Flags can be interspersed with bands of Retro or Tegula Setts, creating a patio with unique charm and character.



Textured Flags Golden with Retro Heather

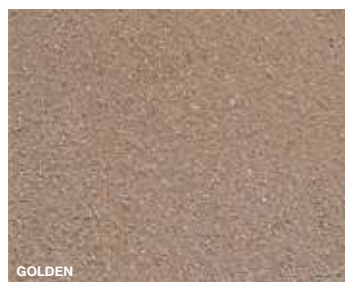

GOLDEN



RED



CHARCOAL



NATURAL

product	size (mm)	finish	edge	colours available	in stock	no. per m <sup>2</sup>	no. per pack	weight (kg) per pack
TEXTURED FLAGS	600 x 600 x 40	PATIO TEXTURED	CHAMFERED	Charcoal, Golden, Natural, Red	YES	2.78	24	840
	400 x 400 x 40	TEXTURED	CHAMFERED	Charcoal, Golden, Natural, Red	YES	6.25	25	400
Edge Step	400 x 400 x 40	TEXTURED (top & 1 edge)	CHAMFERED	Charcoal, Golden, Natural	YES	6.25	25	401
Corner Step	400 x 400 x 40	TEXTURED (top & 2 edge)	CHAMFERED	Charcoal, Golden, Natural	YES	6.25	25	401

The colour of Textured Step Flags may slightly vary to the normal Textured Flag.

**SIZES:** OTHER SIZES AVAILABLE ON REQUEST **INSTRUCTIONS & WARNINGS:** See page 40



# beautiful, long-lasting colours

Riven Flags combine the rugged look of natural stone with the strength and durability of a hydraulically pressed flag. Their small size and light weight make them a popular choice. Riven Flags are economically priced which enables designs to be created at minimum cost.

riven  
flags



Riven Flags Golden



GOLDEN



RUST



CHARCOAL

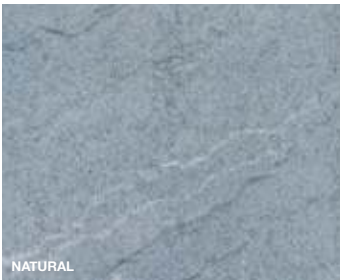

NATURAL

product	size (mm)	finish	edge	colours available	in stock	no. per m <sup>2</sup>	no. per pack	weight (kg) per pack
RIVEN FLAGS	400 x 400 x 40	RIVEN	CHAMFERED	Charcoal, Golden, Natural	YES	6.25	25	392

**SIZES:** OTHER SIZES AVAILABLE ON REQUEST **INSTRUCTIONS & WARNINGS:** See page 40



# standard flags

beautiful, long-lasting colours

Standard Flags are available in an extensive range of sizes and colours with a non-slip smooth finish. A truly versatile and economical flag.



Standard Flags Natural with Pedesta Charcoal

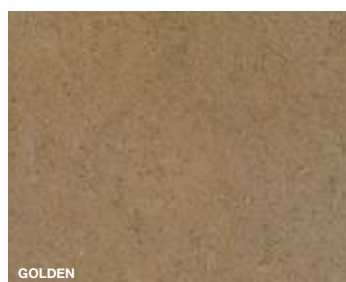

GOLDEN



RED



CHARCOAL

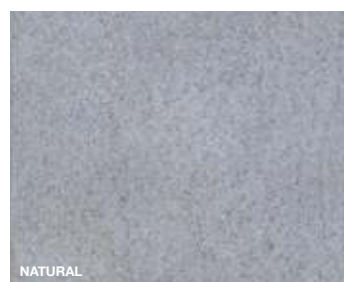

NATURAL

product	size (mm)	finish	edge	colours available	in stock	no. per m <sup>2</sup>	no. per pack	weight (kg) per pack
STANDARD FLAGS	400 x 400 x 40	NON-SLIP SMOOTH	CHAMFERED	Charcoal, Golden, Natural, Red	YES	6.25	25	400
	600 x 600 x 40	PATIO NON-SLIP	CHAMFERED	Charcoal, Golden, Natural, Red	YES	2.78	24	840

**SIZES:** OTHER SIZES AVAILABLE ON REQUEST **INSTRUCTIONS & WARNINGS:** See page 40



The Lansdowne & Kingston facing brick ranges are the perfect choice for creating that timeless appearance of warmth and elegance. Tobermore offer an inspiring range of solid and blended colours for complementary or contrasting architectural designs. Tobermore's experience in product innovation, manufacture and service ensures that when choosing brick, you can be assured of quality, reliability and choice.

# lansdowne & kingston



## lansdowne *tumbled*



## kingston *smooth*

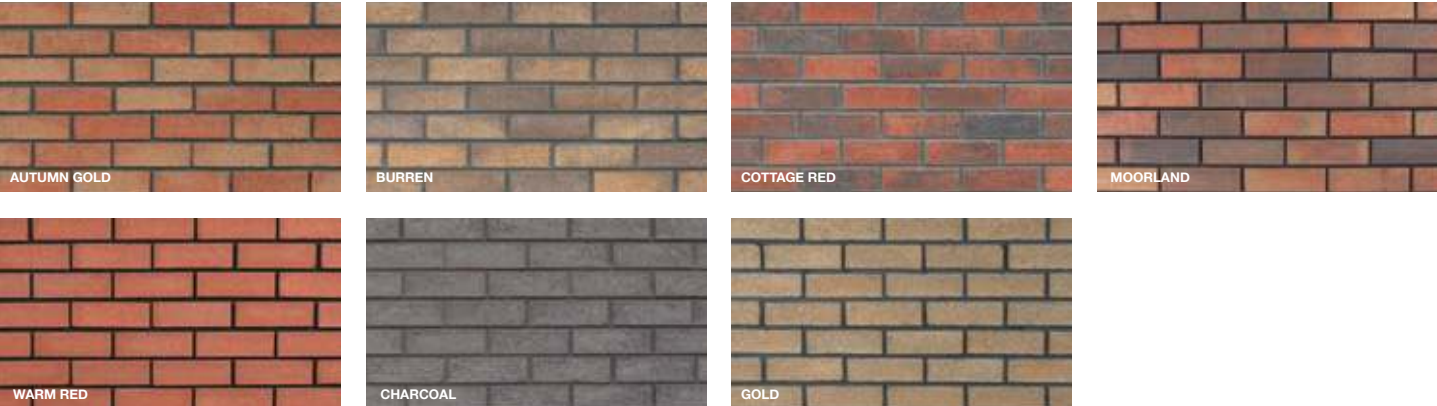

product	size (mm)	colours available	in stock	no. per slice	no. per pack	weight (kg) per pack
LANSDOWNE	215 x 100 x 65	Autumn Gold, Burren, Charcoal, Cottage Red, Gold, Heather, Warm Red	YES	96	480	1360
KINGSTON	215 x 100 x 65	Autumn Gold, Burren, Charcoal, Cottage Red, Gold, Moorland, Warm Red	YES	44	440	1220

INSTRUCTIONS & WARNINGS: See page 40



# country stone

Country Stone is a walling product with an aged-face finish. Its rugged appearance blends perfectly with plants and shrubs in garden and landscape projects.

Country Stone is a popular choice for garden walls and is ideal for house building projects.



Country Stone Bracken

## ORDERING COUNTRY STONE

Contact your local sales office for further assistance on ordering this product.

## RANDOM SIZES AVAILABLE ON REQUEST

Please contact your local sales office for further assistance on ordering this product.



HEATHER



BRACKEN



SLATE

product	size (mm)	colours available	in stock	m <sup>2</sup> per pack	m <sup>2</sup> per slice	no. per pack	weight (kg) per pack
COUNTRY STONE (all sizes in one pack)	375 x 100 x 140	Bracken, Heather, Slate	YES	6.72	1.34	40	1560
	225 x 100 x 140					40	
	160 x 100 x 140					40	
	200 x 100 x 140					40	
	240 x 100 x 140					40	
COUNTRY STONE COPING	208 x 300 x 80	Bracken, Slate, Heather	YES	-	-	128	1416

**SIZES:** OTHER SIZES AVAILABLE ON REQUEST **INSTRUCTIONS & WARNINGS:** See page 40



Garden Stone is a tapered block and is faced on both sides which makes it ideal for creating curved features, planters or for separating areas within the garden. Garden Stone is an ideal DIY walling product which is mortar-free and therefore can be installed quickly with unskilled labour. The blocks are simply glued together and the joints do not require pointing.

# garden stone

free standing double sided wall



Garden Stone Bracken with Garden Stone Coping Bracken



- DOUBLE SIDED
- COST EFFECTIVE
- EASILY INSTALLED
- IDEAL FOR DIY
- SIMPLY GLUE TOGETHER

Garden Stone can be built to a maximum height of 960mm.  
Garden Stone is not a retaining wall product.  
If retention is required please refer to our Secura range.

## Building Garden Stone

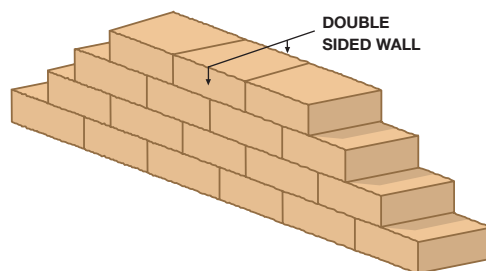
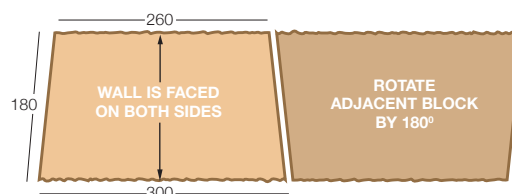

product	size (mm)	colours available	in stock	LM per pack	LM per slice	no. per LM	no. per pack	weight (kg) per pack
GARDEN STONE	300/260 x 180 x 120	Bracken, Heather, Slate	YES	35.28	5.88	3.57	126	1720
GARDEN STONE CORNERS	230/210 x 180 x 120	Bracken, Heather, Slate	YES	-	-	-	126	1720
GARDEN STONE COPING	310/255 x 240 x 70	Bracken, Heather, Slate	YES	-	-	3.5	120	1316

INSTRUCTIONS & WARNINGS: See page 40



# secura lite

retaining wall

Secura's weathered face and unique blended colours make it visually attractive, while the innovative combination of three block lengths gives a random stone appearance.

For our full range of Secura products visit our website [www.tobermore.co.uk](http://www.tobermore.co.uk)



Secura Lite Bracken with Secura Lite Coping Bracken



- MORTAR FREE
- EASILY INSTALLED
- COST EFFECTIVE
- IDEAL FOR DIY

Secura Lite can be built to a maximum height of 960mm.

Detailed installation guidelines can be downloaded from: [www.tobermore.co.uk](http://www.tobermore.co.uk)

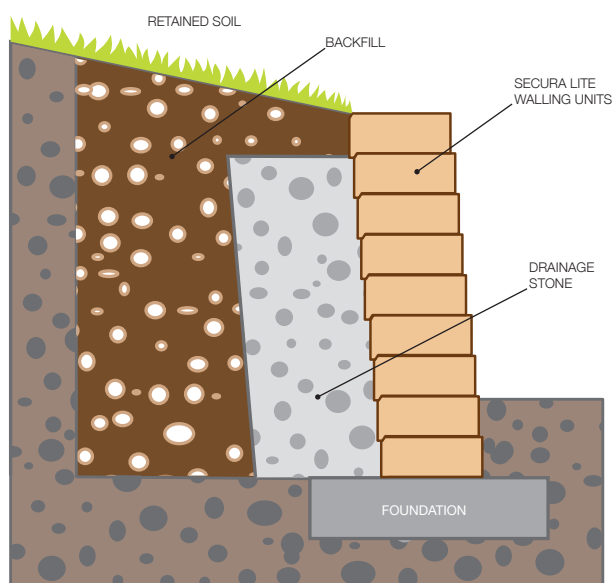

product	size (mm)	colours available	in stock	LM per pack	LM per slice	no. per m <sup>2</sup>	no. per pack	weight (kg) per pack
SECURA LITE (all three sizes in one pack)	320 x 200 x 80	Bracken, Heather, Slate	YES	33.6	0.84	44.64	40	1121
	280 x 200 x 80						40	
	240 x 200 x 80						40	
SECURA LITE COPING	310/255 x 240 x 70 (tapered coping)	Bracken, Heather, Slate	YES	-	-	3.5LM	120	1316

INSTRUCTIONS & WARNINGS: See page 40



Kerbstone's unique aged appearance is ideal for use in areas where a natural and unobtrusive edging is required. Kerbstone will harmonise with gravel paths, as well as areas that have been laid in Tegula paving or textured flags. This versatile edging can also be used to construct steps in various designs.

# kerbstone

no specials required



Kerbstone Heather with Tegula Heather and Tegula Setts Golden



product	size (mm)	colours available	in stock	no. per slice	no. per pack	weight (kg) per pack
KERBSTONE	190 x 160 x 100	Bracken, Cedar, Charcoal, Heather, Natural	YES	35	210	1450
	104 x 173 x 80	Bracken, Charcoal, Heather, Natural	YES	72	504	1628

INSTRUCTIONS & WARNINGS: See page 40



# kerbsett

Kerbsett is an effective replacement for traditional edge restraints. This versatile edging can be laid easily to suit curves and corners. In addition to driveways, it is also highly effective when used as a border for flower beds and paths, preventing soil from washing onto the pavement.



Kerbsett Heather with Shannon Heather and Tegula Setts Golden



HEATHER



BRACKEN



CHARCOAL



BRINDLE

product	size (mm)	colours available	in stock	LM per pack	LM per slice	no. per pack	weight (kg) per pack
KERBSETT	190 x 160 x 100	Bracken, Brindle, Charcoal, Heather	YES	24	4	240	1487

INSTRUCTIONS & WARNINGS: See page 40



Kerb Small (KS) has a dual purpose profile which is a simple, versatile alternative to traditional concrete kerbs.

# kerb small (ks)



CHARCOAL



BRINDLE



HEATHER



BRACKEN



Kerb Small Heather with Pedesta Charcoal

product	size (mm)	colours available	in stock	1m per pack	1m per slice	no. per pack	weight (kg) per pack
KERB SMALL (KS)	125 x 127 x 100	Bracken, Brindle, Charcoal, Heather	YES	43.2	5.4	432	1505

Kerb Large (KL) has a dual purpose profile which is a simple, versatile alternative to traditional concrete kerbs.

# kerb large (kl)

A comprehensive range of specials blocks allow the creation of corners.



CHARCOAL



NATURAL



BRINDLE



HEATHER



BRACKEN



Kerb Large Charcoal with Shannon Heather

product	size (mm)	colours available	in stock	1m per pack	1m per slice	no. per pack	weight (kg) per pack
KERB LARGE (KL)	200 x 127 x 100	Bracken, Brindle, Charcoal, Heather, Natural	YES	28.8	4.8	288	1539

INSTRUCTIONS & WARNINGS: See page 40



# tegula kerb large (tkl)

Tegula Kerb Large (TKL) has a dual purpose profile which is a simple, versatile alternative to traditional concrete kerbs. It will harmonise with Tegula pavements as well as other Tobermore paving products.

A comprehensive range of specials blocks allow the creation of corners.



Tegula Kerb Large Bracken with Tegula Setts Golden



HEATHER

BRACKEN

CHARCOAL

NATURAL

BRINDLE

CEDAR

SLATE

product	size (mm)	colours available	in stock	no. per slice	no. per pack	weight (kg) per pack
TEGULA KERB LARGE (TKL)	200 x 127 x 100	Bracken, Brindle, Cedar, Charcoal, Heather, Natural, Slate	YES	48	288	1539

INSTRUCTIONS & WARNINGS: See page 40



In addition to their standard design, our beautiful Kerbsett, Kerb Large (KL) and Tegula Kerb Large (TKL) products are manufactured in various shapes and styles, referred to as 'Specials'. Kerb Specials each have a unique design, created to meet your specific needs. Kerb Specials also provide the opportunity to incorporate kerbing for different uses around the home.

# kerb specials

## Kerbsett Specials



Right Angle Corner  
External High  
(Type EC/H)



Right Angle Corner  
Internal High  
(Type IC/H)



Right Angle Corner  
External Low  
(Type EC/L)



Right Angle Corner  
Internal Low  
(Type IC/L)



45° Internal Corner  
Low (Type I45/L)  
High (Type I45/H)

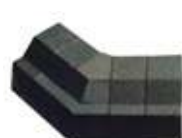

45° External Corner  
Low (Type E45/L)  
High (Type E45/H)



Curves  
(external radius less than 1m)  
Low (Type ER/L)  
High (Type ER/H)



Drop Kerb  
High Position to Low  
(Type H-L)



Transition Kerb  
Low Position to Half Batter  
(Type L-7)  
High Position to Half Batter  
(Type H-7)



End Block  
Low position to End Block  
(Type L-E)



Kerbsett Special Right Angle Corner External High

## Kerb Large (KL) Specials



Half Battered 90° Angle  
Internal



Half Battered 90° Angle  
External



Flat 90° Angle  
Internal



Flat 90° Angle  
External



Bullnosed 90° Angle  
Internal



Bullnosed 90° Angle  
External

## Tegula Kerb Large (TKL) Specials



Half Battered 90° Angle  
Internal



Half Battered 90° Angle  
External



Flat 90° Angle  
Internal



Flat 90° Angle  
External



Bullnosed 90° Angle  
Internal



Bullnosed 90° Angle  
External

**INSTRUCTIONS & WARNINGS:** See page 40

The colour of Kerb Specials may slightly vary to the normal Kerbs.



# kerbs & edging

Choose from our wide range of decorative kerbs and edging products to add the finishing touch to any of our ranges of paving blocks or flags. Edges can be softened by planting close to the path verge and allowing the planting to flow naturally over the edges onto the pavement. Paving blocks can be haunched underneath in concrete, allowing grass or planting to grow up to the paving edge. Tobermore have a full range of kerbs and edging products suitable for both heavy and light duty applications.



Country Kerb Granite Aggregate with Tegula Bracken, Heather and Slate

## Country Kerb & Edge



Country Kerbs have an exposed granular surface, emulating the unique aged appearance of traditional granite kerbs, while maintaining the benefits of modern concrete kerbing. They are available in Granite and Standard finish.

## Garden Edge (flat top)



Garden Edging is ideal for paths and patios and available in either Splayed, Flat Top, Round Top or Rope Top.

## Half Battered Kerb



Traditional Half Battered Kerbs are suitable for driveways or other heavy duty applications.

product	size (mm)	colours available	in stock	no. per pack	weight (kg) per pack
COUNTRY KERB	255 x 125 x 915	Granite Aggregate, Standard Aggregate	YES	18	1251
	255 x 145 x 915	Granite Aggregate	YES	16	1282
COUNTRY EDGE	150 x 75 x 900	Granite Aggregate	YES	60	1200
GARDEN EDGE (flat top)	150 x 75 x 900	Natural	YES	60	1200
HALF BATTERED KERB	200 x 100 x 915	Natural	YES	22	969
	255 x 125 x 915	Natural	YES	18	1232

INSTRUCTIONS & WARNINGS: See page 40



There are no limits to what is achievable when it comes to designing and constructing steps. The renowned versatility of Tobermore products gives you the ability to design and create steps in a wide range of sizes, shapes and colours. You can select various texture and colour combinations to create steps as an attractive feature to any doorway, garden or patio.

# steps & ramps



Kerbstone Charcoal and Tegula Setts Natural



Kerbstone Charcoal with Historic Flags Slate



Mayfair Step Flags Sandstone



Kerbstone Charcoal with Retro Heather



Kerbstone Heather with Sienna Setts Sandstone



Step Risers Charcoal and Tegula Setts Heather



# accessories

Tobermore offer a range of additional landscaping products to complement your driveway or patio project. These products include; jointing sand, maintenance products, recess covers, landscape lighting and decorative stone.

## decorative stone

Tobermore's range of landscaping stone have been blended, selected, coloured and shaped by nature. For driveways, paths, borders and flower beds our range of decorative pebbles will enhance the appeal of your home.



- Suitable for vehicular traffic
- Not suitable for vehicular traffic



■ PINK PEBBLES



■ AUTUMN BROWN PEBBLES



■ SCOTTISH PEBBLES



■ GOLDEN ORCHID PEBBLES



■ NEW FOREST FLINT



■ HAZEL PEBBLES



■ SILVER GRANITE PEBBLES



■ PLUM SLATE

## we also stock

Fine dry jointing sand	For paving brick & coloured flags - covers approx 5-7m <sup>2</sup>
Course dry jointing sand	Recommended for trafficked areas - covers approx 5-7m <sup>2</sup>
Silver granite sand	For use with granite paving & flags - covers approx 5-7m <sup>2</sup>
Rompox Easyfix	Paving fixing mortar
Rompox D1	Paving fixing mortar - 2 part mix
Picseal	Sealer for paving & flags - covers 3m <sup>2</sup> per litre
Stone Seal	Solvent based sealer (dry weather) - covers 4-5m <sup>2</sup>
Aqua Seal	Water based sealer (damp/humid weather) - covers 4-5m <sup>2</sup>
Stain Eraser	Oil & grease stain remover
Stain Remover	Wine, coffee & nicotine stain remover
Anti-moss Paving Cleaner	Moss remover - covers approx 35-50m <sup>2</sup>
Oilaway	Oil remover - 1 litre will treat 4m <sup>2</sup>
Recess Covers (Domestic use only)	300 x 300   450 x 450   600 x 450   600 x 600



Historic Flags & Circle Harvest Gold with Tegula Setts Bracken



# reduced efflorescence

why put up with  
efflorescence  
spoiling your job...

...when you  
can have this.

## what is Efflorescence?

Efflorescence is the single biggest problem encountered by manufacturers of concrete paving products, as the ugly white stains spoil the appearance of the paving and not surprisingly customers are unhappy.

## reduced Efflorescence

Within our manufacturing process we have taken a number of steps to ensure that the occurrence of efflorescence is very significantly reduced on all Tobermore block paving and slabs.



# tobermore approved paving contractor

Choosing a paving contractor is an important decision. Listed below are some questions you should ask. You should take the answers into account in order to make the best informed decision.

- First ask the contractor how long they have been doing this kind of work.
- Ask them to give you names of customers for whom they have carried out similar work. Do not simply take their names. Call these people to check their level of satisfaction or, better still, go and see the work that was done.
- Make sure that you understand the installation plan well, and ask for pictures as well as samples of products, in the colours of your choice.
- Ask them for a written agreement, before commencing work. The agreement should include a detailed description of the proposed work and schedule for executing it.
- Ask the contractor to give you a written guarantee for the quality of their work.
- Ask if they have full Public and Employer Liability Insurance.
- Book your paving contractor well in advance, as there can be a lead in time of 2-3 months for this skilled service.

Having chosen your contractor, it is essential that you meet on-site at the start to explain in detail your exact requirements.

You should then take an active and daily interest in the job to ensure that the work is done to your satisfaction. All too often problems occur because the customer only inspects the job at the end. Remember it is easier and cheaper to make changes as the job progresses than when it is fully installed.

To avoid wastage you must get your paving contractor to accurately measure on site before ordering material from Tobermore. We often find that the dimensions used for the initial project plan are significantly changed on site. Please note that Tobermore do not accept returns on any materials.

### IMPORTANT INFORMATION

Whilst Tobermore takes reasonable steps to vet paving contractors prior to including them on its list of approved paving contractors, Tobermore does not make or give any representation or warranty as to the work carried out by any of its approved paving contractors, nor does it accept any liability for any loss or damage suffered or incurred as a result of the act or omission of any of its approved paving contractors.

For information on how to choose a paving contractor, visit [www.tobermore.co.uk](http://www.tobermore.co.uk)

TOBERMORE CANNOT GUARANTEE THE WORKMANSHIP OF ANY PAVING CONTRACTOR



# instructions & warnings

(As referred to in Tobermore's Conditions of Sale)

## CORE TERMS (PAVING & WALLING)

### Product

All products should be carefully inspected for defects or damage upon delivery and prior to being laid or fitted.

#### Product Information

Within Tobermore, design and development of products is a continuing process, and product information is subject to change without notice. Accordingly, please check with Tobermore to ensure that the product information you have represents the most up-to-date product information.

### Installation

All products should be installed in accordance with the latest British Standard.

### Colour

Tobermore produces paving and walling products with excellent density and durability, however, as with all concrete products, slight colour variations are inevitable. Although every effort is made to ensure consistency of product colour, variations can occur. In particular, single colours such as Golden, Buff, Natural and Red will have variations. Tobermore therefore recommends that products are thoroughly mixed on site by drawing from a minimum of four pallets.

We would always recommend that when purchasing products, especially in larger quantities, that they are all ordered and manufactured in one batch to reduce the chances of getting colour variation. Please note that the colour of new products will inevitably vary compared to those which have been installed for a period of time as weathering does take place.

All colour illustrations in Tobermore's brochures are as accurate as the printing process will allow. For a more accurate colour match please refer to actual product samples, which can be provided.

### Efflorescence

Efflorescence is a white crystalline deposit that occurs naturally on the surface of concrete materials. Tobermore use market leading technology to significantly suppress the occurrence of efflorescence, however, if it occurs, it may mask the colour of the product for a period of time, but tends to be washed away gradually by rain. Tobermore do not replace products with efflorescence. Packs of products which have had packaging removed should always be re-covered with appropriate packaging to prevent the occurrence of secondary efflorescence.

### Surface Scratches

Minor scuffs or bruises may occur during delivery, movement onsite, and installation (for example, during any plate vibrating process). In Tobermore's experience, these marks usually weather off through time.

### Ordering

To avoid waste, please ensure that your contractor accurately measures the area on site before ordering products. In Tobermore's experience, dimensions taken from a project plan can vary significantly from the final layout.

### Manufacturing & Quality Systems

Tobermore is a BS EN ISO 9001, BS EN ISO 14001 and BES 6001 registered company. Tobermore uses an integrated management system to manage all health & safety and environmental issues.

### Product Maintenance

Routine cleaning and maintenance is required to keep the overall appearance of products in pristine condition.

### Laying multi-blend coloured paving blocks, flags and walling products

To achieve an even blend of colour when laying multi-blend paving blocks, flags and walling products, it is desirable to mix from three or four different pallets.

### Queries & Complaints

Please contact one of Tobermore's Paving & Walling Centres or offices (contact details at [www.tobermore.co.uk](http://www.tobermore.co.uk)) with any queries or complaints. Any complaints must be notified to Tobermore without delay.

## CORE TERMS (PAVING ONLY)

### Product Maintenance

Light coloured paving blocks and flags emphasise tyre marks and oil spills on the driveway. Please note that these products will need more maintenance if overall appearance is to be maintained.

### Initial Cleaning

When an area has just been paved, allow it to settle for a few days. After this, you may wish to lightly hose down the paving to remove any excess sand or dirt. The area should then be treated with a weed killer suppressant 2-3 times per year as required.

### General Cleaning

Paving requires regular maintenance, including regular sweeping to prevent the build up of detritus. Tobermore recommends that paving is cleaned 2-3 times per year.

For general cleaning of dirt and algae, vigorous brushing with a stiff yard brush with plenty of hot detergent solution (washing up liquid or non-bio washing powder), thoroughly rinsed with clean water, should suffice. Repeated treatment may be required for paved areas sited beneath trees or in permanent/near permanent shade.

A light power hose at medium pressure is generally all that is required to clean general dirt and grime. Any jointing material which is removed must be replaced. Do not use high pressure powerwashers as aggressive power-washing can damage the product surface. A trial area should be tested before large scale powerwashing takes place.

### Moss, Lichen and Algae

Thick growths of moss or lichen must be removed first by scraping out the joints and then treating the area with a moss killer such as anti-moss paving cleaner. Anti-moss is designed to remove moss, lichens and algae. It is best applied in dry weather. After being applied it will take a few days to be fully effective. Once the moss and lichens have been killed, they can easily be brushed off. Anti-moss also leaves a residue in the sand joint which will help reduce the likelihood of re-growth. The manufacturer's instructions should always be followed when using any cleaning agent.

### Weeds

Large weeds should be removed by hand and then the area treated with a weed killer (available from any good garden centre). Smaller weeds can then be treated directly with weed killer and these weeds should start to die within days. The manufacturer's instructions should always be followed when using any weed killing agent.

### Block Paving Sealer

It is possible to seal block paving with a resin material which combats staining and weed growth and which also enhances colour and appearance. The acrylic sealer is sprayed onto the block paving and forms a 'skin' on top of the paving and the jointing material giving an easily maintained finish. The manufacturer's instructions should always be followed when using any sealing agent.

## FOR HYDROPAVE PRODUCTS

### Installation - Hydropave

Tobermore recommends that its Hydropave products be installed in conjunction with a BS EN 7533-13:2009 designed permeable paving system.

Note: A permeable paving design relies heavily on using the correct aggregates. Prior to installation, we would ask you to test both the 4/20mm coarse graded aggregate and also the 6.3-2mm bedding and jointing grit as per the relevant British Standard specification (BS EN 13242:2002). In particular, the material should be categorised as LA20 according to Table 9, SZ18 according to Table 10 and MDE15 according to Table 11 within this standard. The grit should be insoluble in dilute hydrochloric acid and should be naturally occurring material. In our experience, incorrect use of aggregates is one of the most common reasons for failure of a permeable paving system.

### Joint Filling

All joints must be filled to the top with 6.3 – 2mm grit to prevent movement and spalling of the blocks. We recommend that after a few weeks use, any joints which have settled and are not full, are topped up with grit. Joints should be kept filled at all times. You will need approximately one tonne of grit for every 100m<sup>2</sup> of 80mm paving.

Note: Care should be taken that the permeable joints do not become contaminated as work on the

scheme is completed. Special care needs to be taken when soft landscaping is carried out so that soil does not enter the joints. When this type of work is being carried out, the surface of the permeable paving should be protected by an appropriate cover to protect the joints from being contaminated.

## FOR FACING BRICK PRODUCTS

### Installation – Facing Bricks

Please refer to Tobermore's detailed 'Guide to the use of Tobermore Concrete Bricks' available on our website: [www.tobermore.co.uk](http://www.tobermore.co.uk)

### Good Practice during Construction

- If mortar dry's on the surface of the bricks it will stain the product and may not be removed.
- Mortar extruding from joints should be removed when the mortar is wet and during the process of laying.
- Any mortar smears on the brick surface should be removed by dry or wet brushing.
- Scaffolding should be installed as per regulatory instructions. Please note that mortar can drop and hit the scaffolding and then also go onto the wall. You should inspect the work area at all times to ensure the brick surface remains mortar free.
- When it rains be careful that any wet mortar on the scaffolding does not get 'splashed' onto the wall.
- When work stops or is interrupted by inclement weather conditions, brickwork should be protected immediately with polythene sheeting that is held in place with a suitable fixing. If new brickwork is not protected efflorescence, patchy mortar colour, patchy brickwork and staining can occur.
- Bricks should always be covered with polythene sheets to avoid getting damp or dirty when not being used.

### General Cleaning Advice

- It is always important to keep bricks as clean as possible while laying and tooling. See Good Practice above.
- If mortar has been allowed to dry on the surface of the bricks the options you have to clean it off are as follows; Each process should be tested first and should ensure the facing bricks are not damaged - a. Dry brushing b. Wet brushing c. Using a 'like coloured' brick to rub the stained brick d. Pressure washing - should only be used as a last resort as it will damage the surface and the mortar joint if not completed correctly (this method cannot be attempted until the area has been allowed to set for a minimum of 7 days).
- Acid cleaning should be avoided.

## FOR COUNTRY STONE PRODUCTS

### Installation – Country Stone

Tobermore's Country Stone products are designed to recreate traditional stone sizes and to co-ordinate with standard cavity wall construction. When used in housing projects, a clear cavity must be retained.

All work must be protected during construction and must be designed and built in accordance with accepted industry standards and practice. Builders familiar with conventional brickwork will find that similar installation principles apply.

Joints can be finished flush or tooled depending on the overall effect required. Raked joints are not recommended. It is vital that all horizontal and vertical joints between Country Stone blocks must be compacted and free from voids. Shell bedding should not be used.

### Movement Joints and Mortar Guidance

1. NHBC recommends that walls constructed of concrete facing bricks should have vertical movement joints included every 6m to allow for drying/shrinkage, see PD6697:2010 section 6.2.6.3.4, maximum ratio for brickwork panels is to be 3:1 length : height. PD6697:2010 section 6.2.6.4 gives advice on joint positions, the benefit of brickwork reinforcement at window openings is covered in section 6.2.6.7 of the same document. Movement joints should be planned prior to commencing any construction to enable them to be concealed behind down pipes etc. and ensure the aesthetic of the building is maintained.

2. It is important to ensure that the mortar specified for the construction is suitable for the contract, see table 15 of PD6697:2010 - class M4 is the maximum recommended for normal external facing brick walls. This should not be exceeded when using Tobermore Concrete facing bricks.

3. We would recommend that you discuss this guidance with all parties involved in the design, construction and installation of this scheme. We also recommend that you refer to BS EN 1996-1-1 and PD6697:2010.

4. Specific professional advice should be obtained at all times before commencing building work.

### Good Practice during Construction

- If mortar dry's on the surface of the bricks it will stain the product and may not be removed.
- Mortar extruding from joints should be removed when the mortar is wet and during the process of laying.
- Any mortar smears on the brick surface should be removed by dry or wet brushing.
- Scaffolding should be installed as per regulatory instructions. Please note that mortar can drop and hit the scaffolding and then also go onto the wall. You should inspect the work area at all times to ensure the brick surface remains mortar free.
- When it rains be careful that any wet mortar on the scaffolding does not get 'splashed' onto the wall.
- When work stops or is interrupted by inclement weather conditions, brickwork should be protected immediately with polythene sheeting that is held in place with a suitable fixing. If new brickwork is not protected efflorescence, patchy mortar colour, patchy brickwork and staining can occur.
- Bricks should always be covered with polythene sheets to avoid getting damp or dirty when not being used.

### General Cleaning Advice

- It is always important to keep bricks as clean as possible while laying and tooling. See Good Practice above.
- If mortar has been allowed to dry on the surface of the bricks the options you have to clean it off are as follows; Each process should be tested first and should ensure the facing bricks are not damaged - a. Dry brushing b. Wet brushing c. Using a 'like coloured' brick to rub the stained brick d. Pressure washing - should only be used as a last resort as it will damage the surface and the mortar joint if not completed correctly (this method cannot be attempted until the area has been allowed to set for a minimum of 7 days)
- Acid cleaning should be avoided.

## FOR SECURA PRODUCTS

### Installation - Secura

All Secura products should be installed in accordance with British Standard BS8002. When constructing a retaining wall, ensure that you follow the design provided by the scheme engineer.





# Tobermore

PAVING & WALLING

## **Tobermore**

2 Lisnamuck Road, Tobermore  
County L'derry, BT45 5QF

**Tel: 028 7964 2411**

**Fax: 028 7964 4145**

## **Bangor**

The Dickson Home & Garden Complex  
79 Cootehall Road, Bangor  
County Down, BT19 1UP

**Tel: 028 9185 2545**

**Fax: 028 9185 2596**

## **Dublin**

Blakes Cross, Lusk  
County Dublin

**Tel: 01 8437440**

**Fax: 01 8437750**

## **Cork**

Mill Road, Irish Town  
Cross, Bandon, County Cork

**Tel: 023 8843046**

**Fax: 023 8843047**



[www.tobermore.co.uk](http://www.tobermore.co.uk) |   

[www.tobermore.ie](http://www.tobermore.ie)